

PATENTED

MEM - MEDICAL EXCLUSIVE MATERIAL

Neutral / Personalized plastic insert

OVAL SHAPE | 13mm

Regular Pad

STYLE MAX

ANTI-LOSING SCREW SYSTEM

Material: Soft MEM Crystal Warm
Insert: PC insert "C Shape"

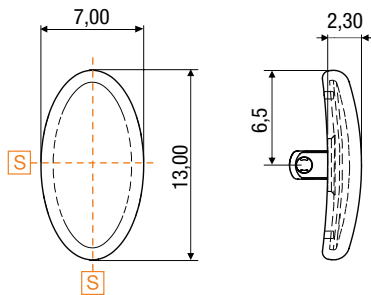

Insert colour: NICKEL

SCREW SYSTEM | 81NPCK959A1WDX

Insert colour: GOLD

SCREW SYSTEM | 81NPCK959A2WDX

Insert colour: RUTHENIUM

SCREW SYSTEM | 81NPCK959A3WUX



Anti-losing screw system

Patented double groove anti-losing screw system holds the nose pad firmly in place, making sure the screw does not drop or get lost.



Stainless Screw for STYLE MAX pad arm
Code: 07VICJ595A1BYX