

# NICKEL SILVER 18% Ni MATERIAL

## Ergofeel® System Pad Arms

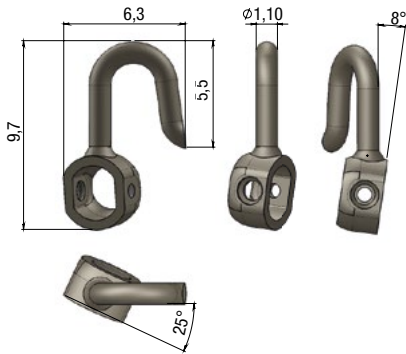

**PAD ARM**

<b>ERGOFEEL® SYSTEM</b>	03PDC4463A1BY0
-------------------------	----------------

Stem code: OA7428  
 Stem shape: 207  
 Stem Ø 1.10  
 Stem alloy Nickel Silver 18% Ni · CuNi18Zn20

**ERGOFEEL® BOX**  
 ERGOFEEL® box alloy Nickel Silver 18% Ni · CuNi18Zn20  
 Slanted ERGOFEEL® box 25°\*8°

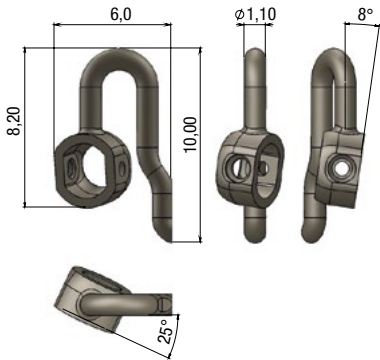

**PAD ARM**

<b>ERGOFEEL® SYSTEM</b>	03PDB1268A1BY0
-------------------------	----------------

Stem code: OA7578  
 Stem shape: 214  
 Stem Ø 1.10  
 Stem alloy Nickel Silver 18% Ni · CuNi18Zn20

**ERGOFEEL® BOX**  
 ERGOFEEL® box alloy Nickel Silver 18% Ni · CuNi18Zn20  
 Slanted ERGOFEEL® box 25°\*8°

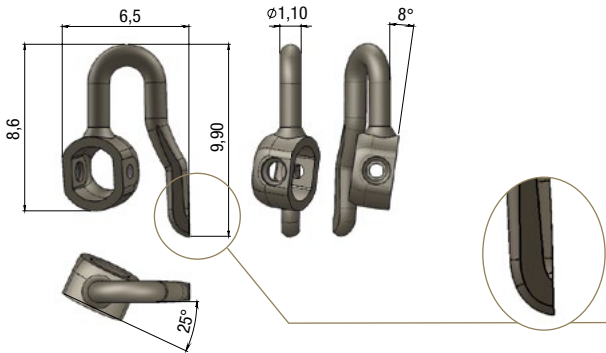

**PAD ARM**

<b>ERGOFEEL® SYSTEM</b>	03PDC4462A1BY0
-------------------------	----------------

Stem code: ROA0121  
 Stem shape: 214  
 Stem Ø 1.10  
 Stem alloy Nickel Silver 18% Ni · CuNi18Zn20

**ERGOFEEL® BOX**  
 ERGOFEEL® box alloy Nickel Silver 18% Ni · CuNi18Zn20  
 Slanted ERGOFEEL® box 25°\*8°  
**STAMPED STEM 0.9 mm AT THE END**

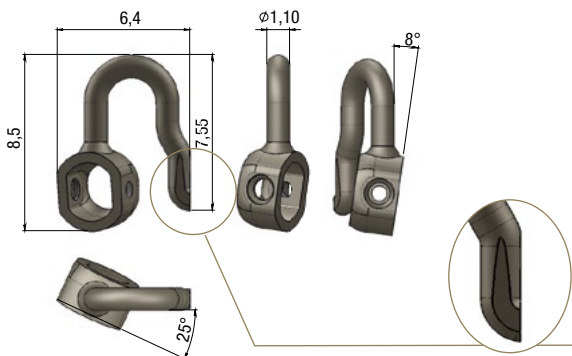

**PAD ARM**

<b>ERGOFEEL® SYSTEM</b>	03PDC4461A1BY0
-------------------------	----------------

Stem code: ROA0011  
 Stem shape: 214  
 Stem Ø 1.10  
 Stem alloy Nickel Silver 18% Ni · CuNi18Zn20

**ERGOFEEL® BOX**  
 ERGOFEEL® box alloy Nickel Silver 18% Ni · CuNi18Zn20  
 Slanted ERGOFEEL® box 25°\*8°  
**STAMPED STEM 0.9 mm AT THE END**